

Quick-fix anchor BA A4



Advantages



- Quick-fix anchor made of stainless steel A4 for fast installation in non-cracked concrete
- The BA A4 can be used for a wide range of approval relevant applications for outdoor usage, facade substructures aso.
- High load values and at the same time small edge and axial distances; usable even in tough installation situations

Approvals and certificates



Suitable building materials

Very suitable



- Concrete



Suitable to a limited extent

- Dense natural stone (up to M8)

Mounting

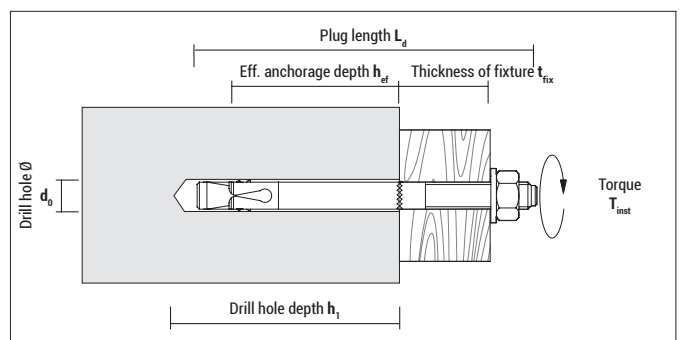
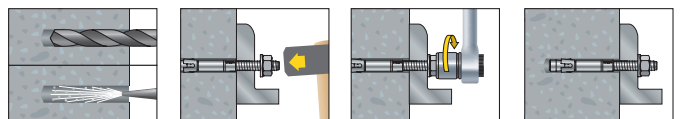

Quick-fix anchor BA A4



BA A4, stainless steel A4

Type	Art-No	d ₀ [mm]	h ₁ ≥ [mm]	h _{ef} ≥ [mm]	L _d [mm]	t _{fix} ≤ [mm]	Thread	ETA	€/100 pcs	Box [pcs]	Tray [pcs]
8-72/10 A4	9X872BA	8	60	45	72	10	M8	●		50	250
8-92/30 A4	9X892BA	8	60	45	92	30	M8	●		50	250
8-112/50 A4	9X8112BA	8	60	45	112	50	M8	●		40	200
10-92/10 A4	9X1092BA	10	75	60	92	10	M10	●		40	200
10-102/20 A4	9X10102BA	10	75	60	102	20	M10	●		25	125
10-112/30 A4	9X10112BA	10	75	60	112	30	M10	●		25	125
10-132/50 A4	9X10132BA	10	75	60	132	50	M10	●		25	125
12-103/5 A4	9X12103BA	12	90	70	103	5	M12	●		20	100
12-118/20 A4	9X12118BA	12	90	70	118	20	M12	●		20	100
12-128/30 A4	9X12128BA	12	90	70	128	30	M12	●		20	100
12-148/50 A4	9X12148BA	12	90	70	148	50	M12	●		20	100
12-163/65 A4	9X12163BA	12	90	70	163	65	M12	●		20	100
16-123/5 A4	9X16123BA	16	110	85	123	5	M16	●		10	50
16-138/20 A4	9X16138BA	16	110	85	138	20	M16	●		10	50
16-168/50 A4	9X16168BA	16	110	85	168	50	M16	●		10	50

Installation parameters

BA Size		M8	M10	M12	M16
Torque	T _{inst} [Nm]	20	35	70	120
Width across flats	SW [mm]	13	17	19	24
Ø of clearance hole in fixture	d _r [mm]	9	12	14	18
Washer outer Ø x thickness	[mm]	17 x 1,6	21 x 2,0	24 x 2,5	30 x 3,0

Loads, spacing and edge distance BA A4 approved sizes M8 - M16

Type	Permissible loads in concrete ¹⁾²⁾³⁾		Permissible bending moment M _{per} [Nm]	Spacing ⁴⁾		Edge distance ⁴⁾		Min. thickness of structural part h _{min} [mm]
	C 20/25 Tension N _{per} [kN]	C 20/25 Shear V _{per} [kN]		S _{min} [mm]	S _{cr} [mm]	C _{min} [mm]	C _{cr} [mm]	
BA A4 8	3,6	6,3	12,6	50	135	50	68	100
BA A4 10	6,3	9,7	25,7	55	180	50	90	120
BA A4 12	7,9	14,3	45,1	60	210	55	105	140
BA A4 16	16,7	26,9	114,3	70	255	85	128	170

¹⁾ Permissible loads for single anchor without influence of spacing and edge distance.
²⁾ Load figures include the resistances' partial safety factors as per ETA assessment and a partial safety factor on the action of v_F = 1,4.
³⁾ For higher concrete strengths up to C50/60 the values increase by max. 28%.
⁴⁾ If underrun the char. spacing or edge distance (C_{cr} or S_{cr}) the loads must be reduced. h_{min}, S_{min} and C_{min} must be observed.