

Push-in plug InsertFIX



Advantages



InsertFIX IFS, small head

InsertFIX IFB, big head

- Very fast installation system. Just drill a hole \varnothing 6 mm and push the plug into the drill hole by hand
- The InsertFIX can be used in almost all base materials
- Due to the special barbs a simple installation is possible with high pull-out loads at the same time
- Made out of age-resistant nylon
- The notch in the head hole prevents slipping of the cable tie

Suitable building materials

Very suitable



- Concrete
- Natural stone
- Solid brick
- Solid sand-lime brick
- Lightweight solid concrete blocks
- Aerated concrete
- Hollow brick
- Hollow sand-lime brick

Approvals and certificates



Mounting

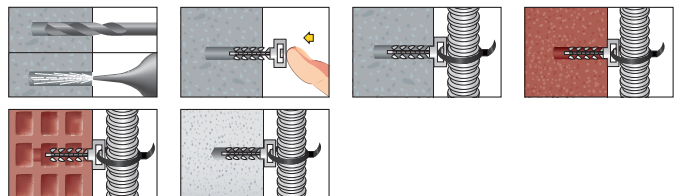

Push-in plug InsertFIX

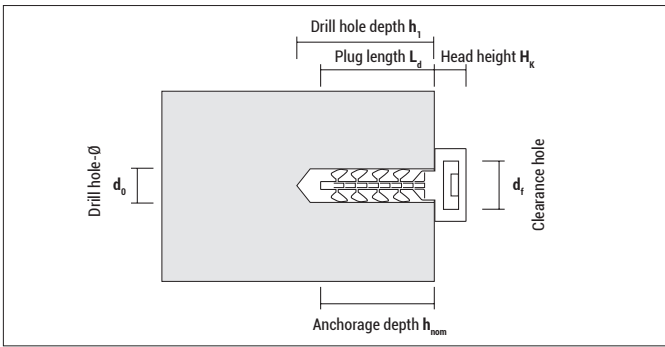

InsertFIX IFS with small head

| Type | Art-No | Colour | d_0 [mm] | L_d [mm] | $h_1 \geq$ [mm] | h_{nom} [mm] | H_k [mm] | d_t [mm] | € / 100 pcs | [pcs] | [pcs] |
|-------------|--------|--------|---------------|---------------|--------------------|-------------------|---------------|---------------|----------------|-------|-------|
| IFS 6 grey | 96IFS | grey | 6 | 31 | 30 | 25 | 6 | 5,5 | | 100 | 4.800 |
| IFS 6 black | 946IFS | black | 6 | 31 | 30 | 25 | 6 | 5,5 | | 100 | 4.800 |



InsertFIX IFB with big head

| Type | Art-No | Colour | d_0 [mm] | L_d [mm] | $h_1 \geq$ [mm] | h_{nom} [mm] | H_k [mm] | d_t [mm] | € / 100 pcs | [pcs] | [pcs] |
|-------------|--------|--------|---------------|---------------|--------------------|-------------------|---------------|---------------|----------------|-------|-------|
| IFB 6 grey | 96IFB | grey | 6 | 31 | 30 | 25 | 6 | 10 | | 100 | 2.700 |
| IFB 6 black | 946IFB | black | 6 | 31 | 30 | 25 | 6 | 10 | | 100 | 2.700 |

Loads and dimensions F_{rec}

| Type | Concrete 20/25 F_{rec} [kN] | Solid sand-lime brick F_{rec} [kN] | Hollow brick HLz 12 F_{rec} [kN] | Lightweight hollow concrete blocks F_{rec} [kN] |
|-----------|----------------------------------|---|---------------------------------------|---|
| IFS / IFB | 0,08 | 0,08 | 0,08 | 0,08 |

F_{rec} : Recommended load in all directions incl. safety factor of 5